

David Harding

From: Tandy Walker [tandyw@flash.net]
Sent: Saturday, December 05, 2009 10:24 AM
To: Undisclosed-Recipient: ;@smtp107.sbc.mail.mud.yahoo.com
Subject: A Modeler's 75th Birthday

Today, December 5, 2009, is Tandy's birthday. He is 75 years old today. You may not know it, but he has been involved in building radio control models ever since he was a freshman in engineering school at the University of Oklahoma. Pictures were taken of most all of his models so he took some time and scanned in just the R/C models to share his 55 year history of radio control modeling in chronological order with you.....Tandy

1954 R/C Trixter Beam (Arden .099)



1956 R/C Racer (my own design) (Arden .099)

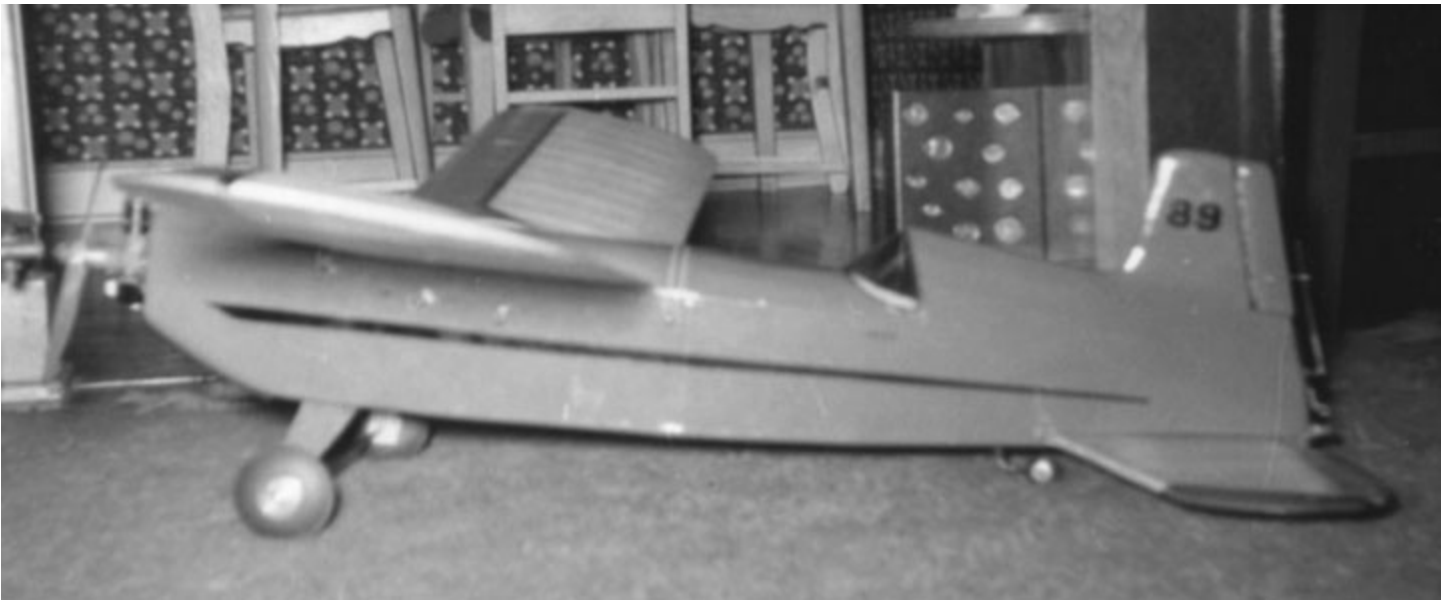

1957 R/C 6' J-3 Cub (K&B .23)



1960 R/C Bi-Fly (K&B .15)

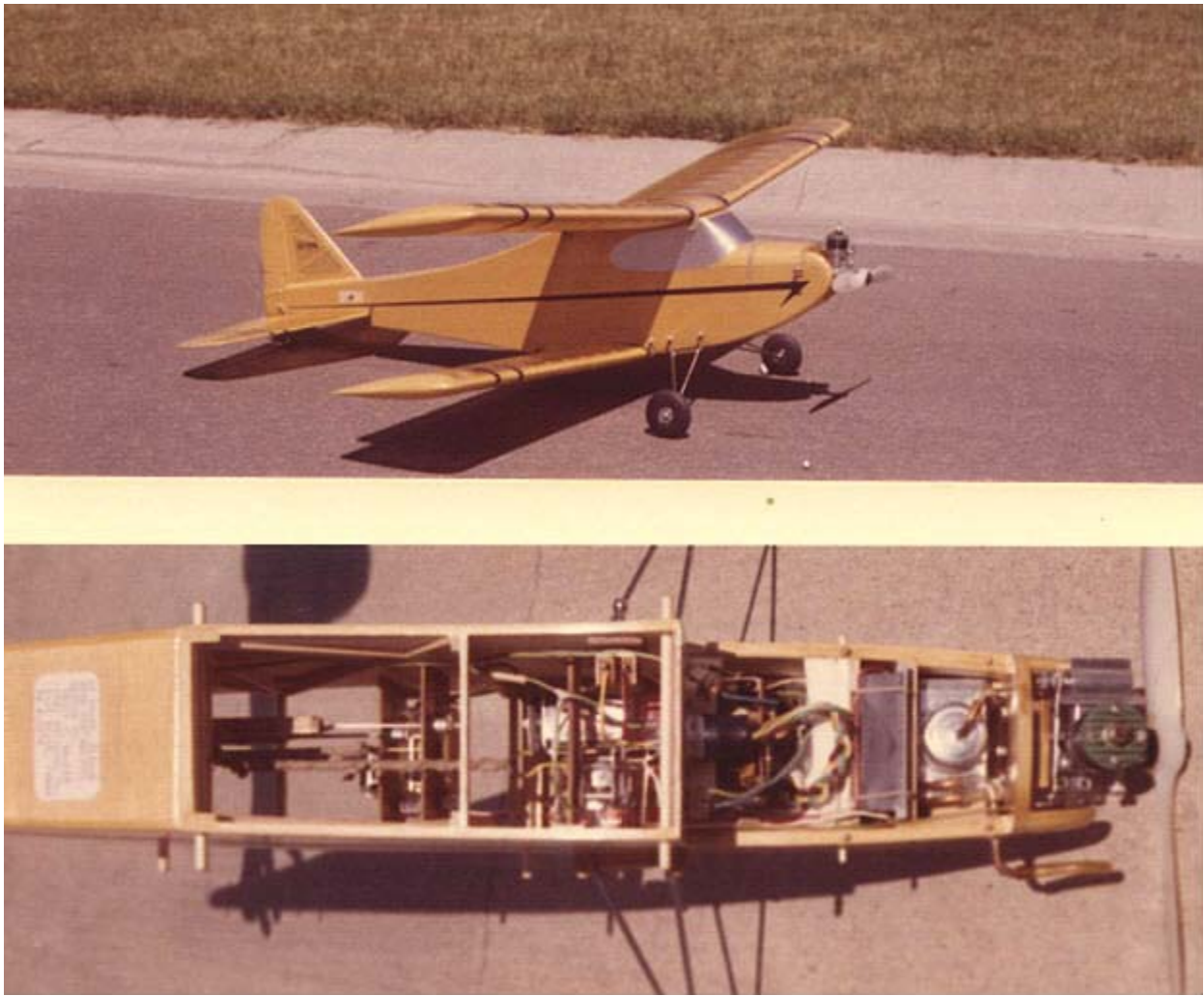

1960 R/C Midwest Esquire (K&B .15)



1960's spent building a Smith Miniplane (*Biplane*)



I have been a pilot since I was 16.



1973 R/C Midwest AristroCat (Veco .50)



1976 R/C Hoss Fly (*built for my son, Cy*) (Webra .40 Black Head)



1977 R/C Super Kaos (HP .61)



1977 R/C Super Kaos
(My first set of retractable landing gears)



1978 R/C Quaker (Webra .40 Speed)



1980 R/C Kaos 40 (Webra .40 Speed)



1986 Shershaw's R/C 110% Cumulus (OS .60 RSR Black Head)



1986 Shershaw's R/C 110% Cumulus (OS .60 4-Stroke)



1991 Beginning the R/C Monocoupe 90A

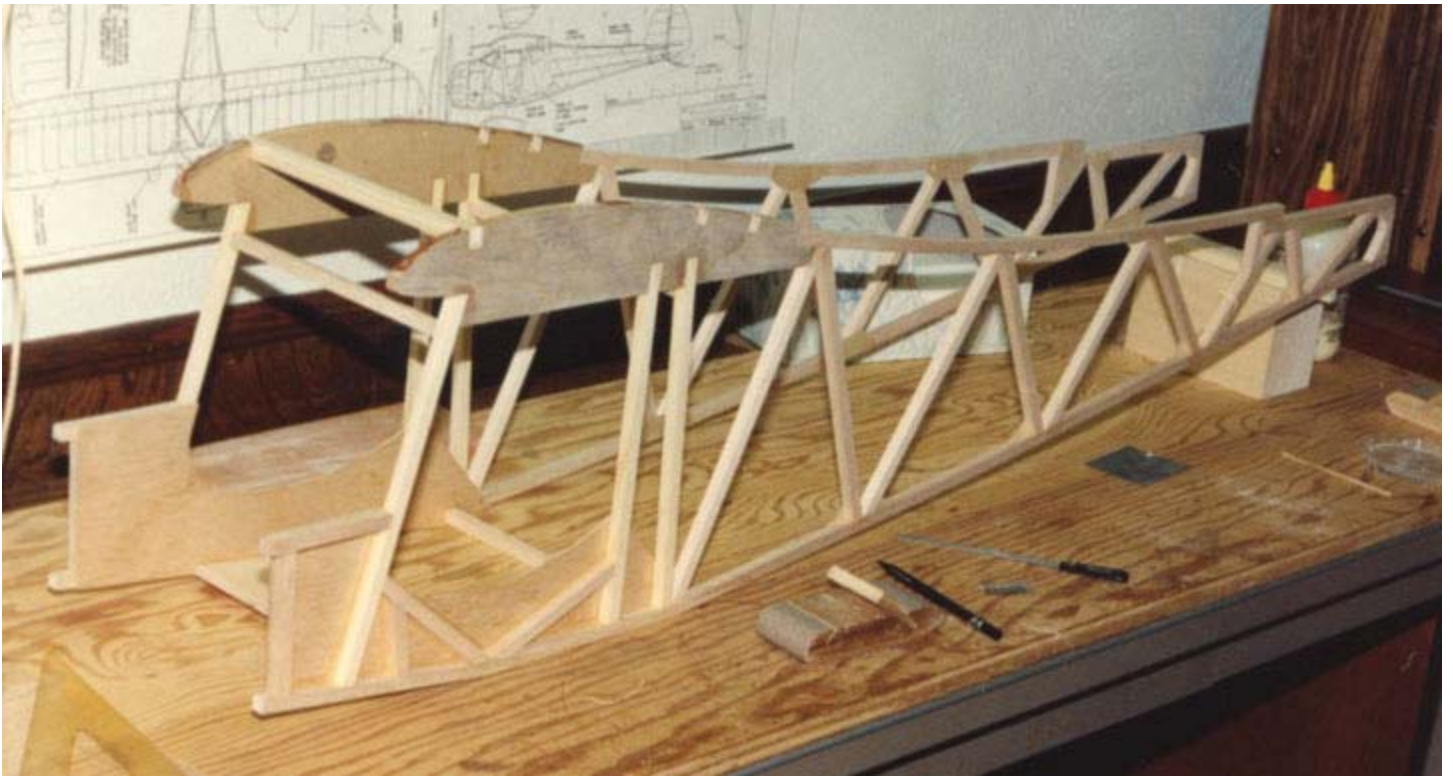

1992 R/C 139% Hoss Fly (Zenoah G23)



1994 R/C Cleveland Playboy (Shilen Torpedo .29)



1995 R/C Monocoupe 90A (Zenoah G38)



1996 Shershaw's R/C 83% Cumulus (Wiley .36)



1997 Shershaw's R/C 63% Cumulus (Shilen OT .19)



1998 R/C 1207 sq. in. Lanzo Bomber (Edco Sky Devil .65)



1999 R/C Folly (Ohlsson .60 Sideport)



2000 R/C 415 sq. in. Lanzo Bomber (Shilen OT .19)



2000 R/C 300 sq. in. Korda Wakefiled Electric (Speed 400 Electric Motor)



2001 R/C Super Doubler II (Saito FA-50 ABC 4 Stroke)



2003 R/C 600 sq. in. Fubar 600X (Veco .35)



2004 R/C 415sq. in. Lanzo Bomber
(Second One Built)

SAM Champs

by Charlie Reich

2 0 0 4



Tandy Walker (Arlington TX) scaled his Lanzo Bomber down to a 55-inch span to compete in Class A and B. Power is a Shilen OT .19 ignition engine. Covering is Polyspan.

THIS WAS THE 38th year that the old-timers—men and models—gathered in early September for the Society of Antique Modelers (SAM) annual SAM Championships—an event based on the original Nationals held during the Golden Age of model aviation in the 1930s. The 2004 SAM Champs was held at the beautiful AMA flying site in Muncie, Indiana.

In the 1920s and early 1930s, all contests were for gliders or rubber-powered models. In 1933 modeling took a giant leap forward when 18-year-old Maxwell Bassett walked up to the registrar with his schoolmate friend Bill Brown and signed up to enter a Mulvihill (rubber-model) contest. Chaos erupted when Bill fired up his new gas engine, for which he had recently designed and built the prototype in his high-school machine shop.

The model—which Max designed—was “Miss Philadelphia.”

April 2005 43

2005 490 sq. in. R/C Lanzo Airborn (Shilen Torpedo .29)



2007 R/C 1207 sq. in. Lanzo Bomber (Series 20 McCoy .60)
Second One Built



Powered with a Series 20 McCoy 60



2009 R/C 890 sq. in. Comet Sailplane (Series 20 McCoy .60)



300 sq. in. R/C Cleveland Cloudster (Speed 400 Electric Motor)
(Work in Progress)

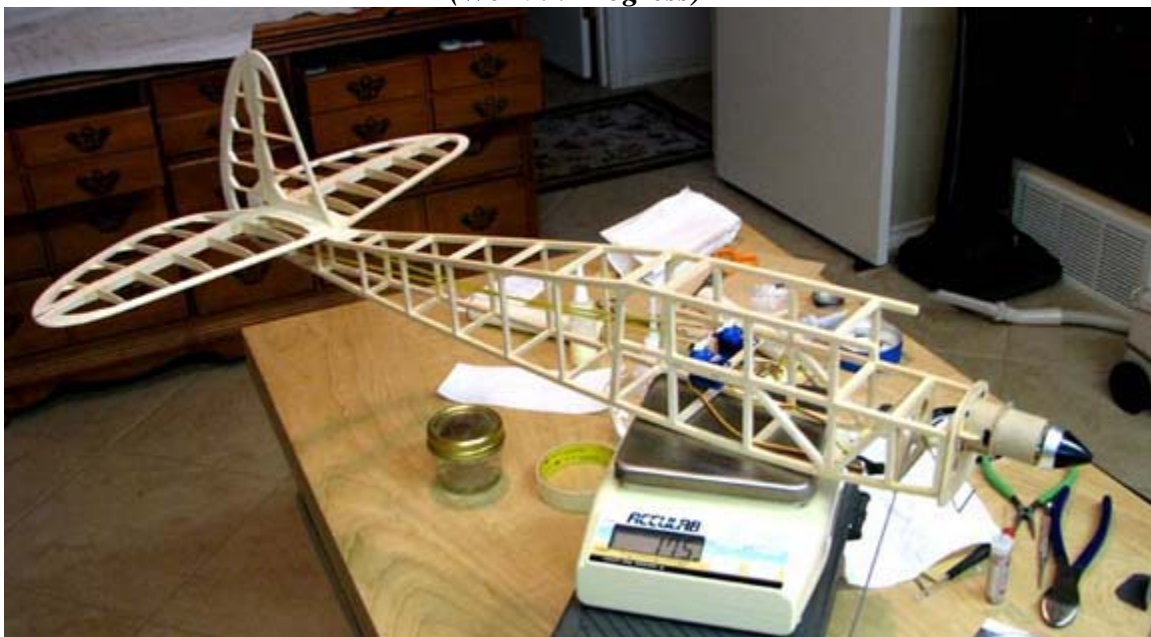

The End